

INSTRUCTION MANUAL

Ctrl/AX

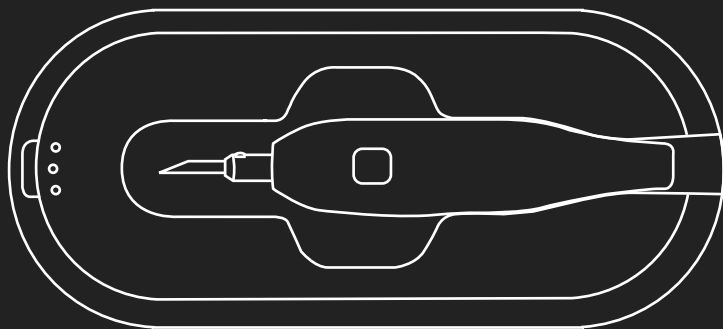

Select and Cut

INDEX

01	Components	
	Main body _____	01p
	handpiece (cutter) _____	01p
	Components _____	01p
02	Instructions for use	
	How to use the product _____	02p
	Description of it's state _____	03p
	Pre-use checks and precautions _____	04p
03	Product management	
	Replacement of blades and blade fixtures _____	05p
	Information on blades and blade fixtures _____	06p
04	Safety precautions	
	Warnings and precautions for safety _____	07p
05	Customer service	
	Damage compensation guidelines for consumers _____	09p
	Product specifications _____	09p
06	Self-Check	
	Before requesting A/S _____	10p
07	About us	
	Recommended materials for use _____	12p
	Certificate _____	12p

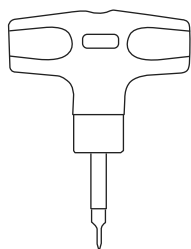
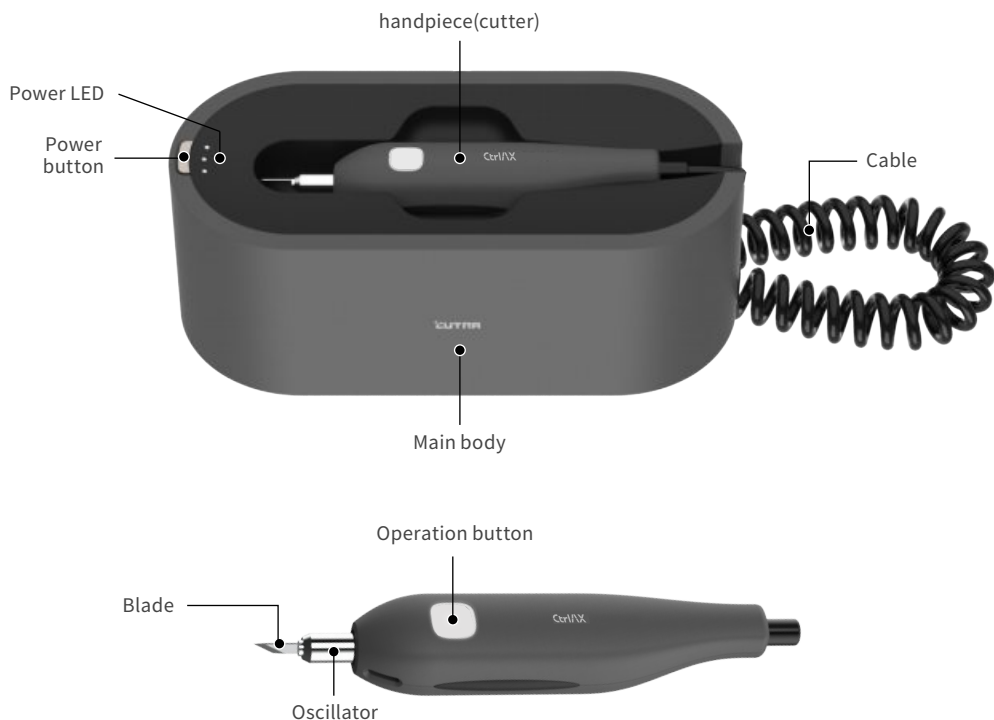

Torque wrench

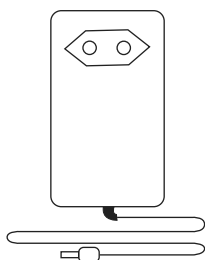

Adapter

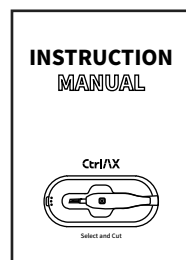
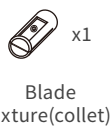
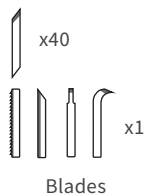

Manual

Instructions for use

1

Press the power button for 2 seconds to turn it on.

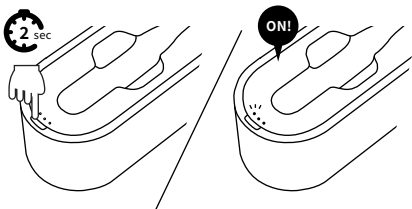

2

Press the operation button to start cutting.

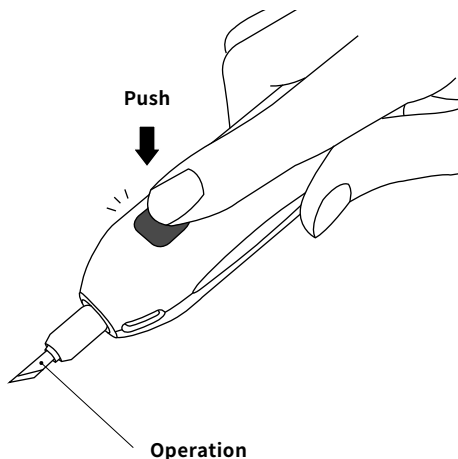

3

Press the power button for 2 seconds to turn it off.

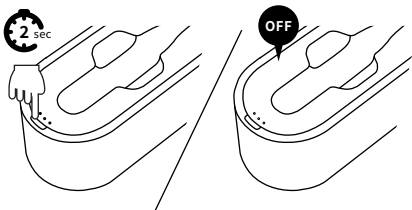

Continuous operation mode

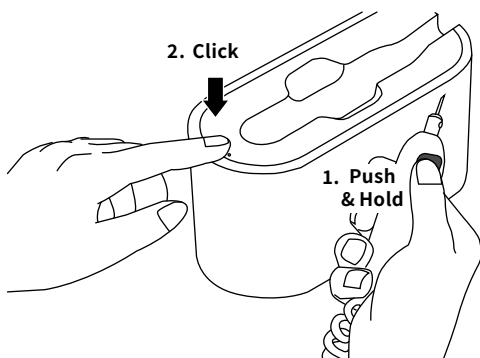

Press the operation button first and then press the power button.



1. Eco Mode

2. Comfort Mode

3. Sport Mode

The mode can be switched by pressing the power button.

Click

on

off

► 3 types of modes

Press the power button of the main body to enter the standby mode.
You can check your current mode by the number of LEDs lit.

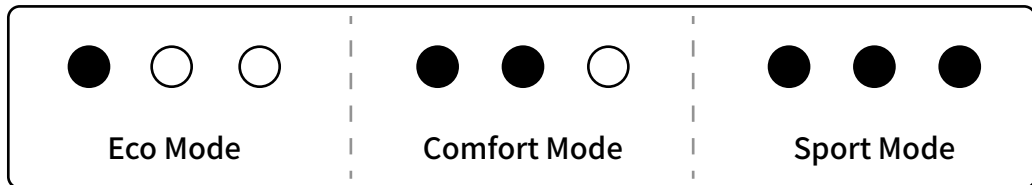

Standby mode after the beep sound

This is the state which protection function is activated due to the high-temperature vibration heat in the circuit after continuous vibration mode.

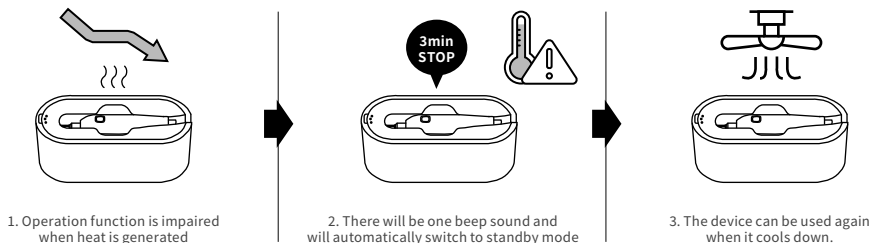

Checklist

If there are any problems with the components, please check the following.

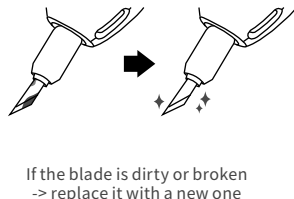
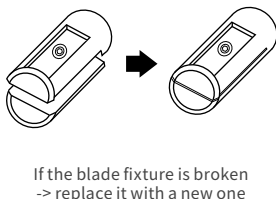
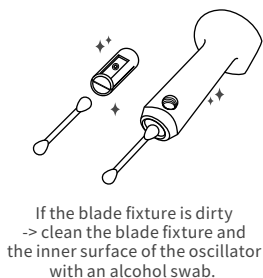

pre-use checks and precautions

► Precautions for use

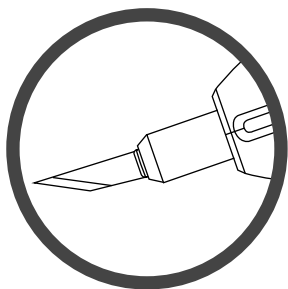

Check if the blade is properly attached to the handpiece

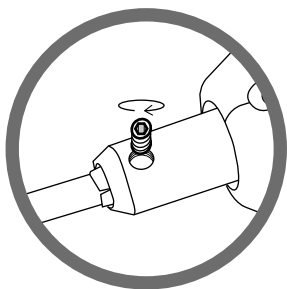

Ensure that the set screw is tightly fastened for safety

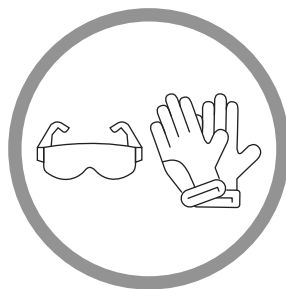

Please wear safety glasses, gloves, and other necessary protective gears

► Precautions before use

- CtrlAX cuts better than regular knives. handpiece with care.
- Make sure the provided power adapter is properly connected.
- Wear appropriate clothing for the job.
- Always turn off the power button and attach the handpiece to the main body when not using CtrlAX.
- Secure the workpiece firmly during use.
- This product cannot be used on **metals or glass**.
- Harmful gases may be generated during cutting depending on the material being cut. Wear a protective mask and ensure adequate ventilation.

► Precautions when there is a beep sound

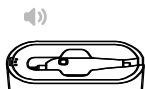

Overheating symptoms

When the temperature of the oscillator rises, there will be a long beep sound once, and the power will be turned off. It will switch to a standby mode for 3 minutes due to overheating. After 3 minutes, there will be a long signal sound once more.

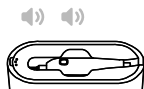

Overcurrent symptoms

The device will make two beep sounds and stop its performance in the following situations.

1. When cutting hard objects such as metal or glass.
2. When the blade is stuck in a hard object.
3. When excessive force is applied during cutting.

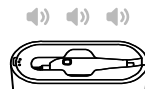

Blade non-detection symptoms

If the following situations occur, a signal sound will be emitted 3 times and the power will be turned off

1. When the blade is not attached.
2. When the set screw is not tightened properly.

Replacement of blades and blade fixtures

► Replacing blade and the blade fixture

1. Turn off the power and remove the blade by loosening the set screw.
2. Place the new blade in the concave part of the blade fixture. Do not assemble the blade and set screw diagonally
3. Tighten the set screw until it makes a "click" sound with a torque wrench.
4. After ensuring that the blade is tightened, turn on the main power and press the operation button to see if it works normally.

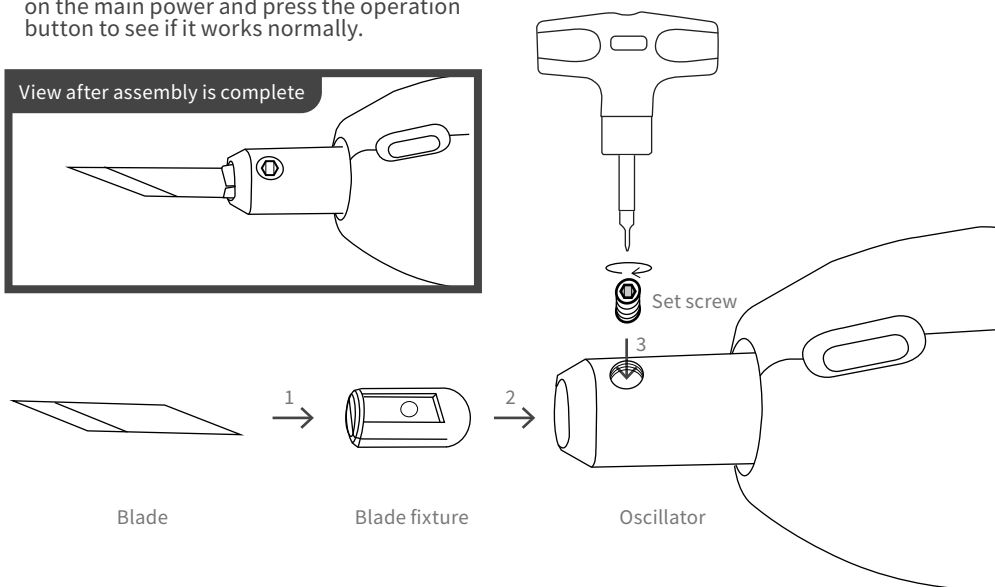
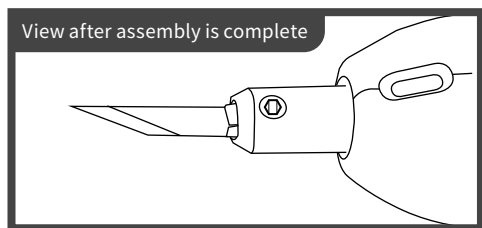

► Precautions for replacing blade and the blade fixture

- Turn off the power of the device.
- If the blade or the blade fixture is contaminated or damaged, such as being blackened, remove the contaminants or replace them with new ones.
- If it is not working properly, wipe the oscillator with a cotton swab. (After cleaning it with alcohol, make sure it is fully dried before assembly.)
- Use a torque wrench to tighten the set screw.
- Be careful not to get injured when handling the blade.
- Be careful because the blade, collet, mountain bolt, and the oscillator are very hot right after use because of the frictional heat generated by ultrasonic vibration.

► Regarding the blade and the blade fixture

1. Use the provided blade and the set screw.

* Make sure the blade and the set screw are securely fastened before use.

2. Stains on the blade or blade fixture can cause overheating, noise, and product damage.

* Before use, check for stains on the blade and blade fixture and replace them if there are any stains.

3. If a set screw other than the provided by our company is used for fastening, it may not properly tighten and thus may not work properly.

► When replacing the blade fixture

- Using blades other than provided or having a loose set screw may cause the machine to malfunction, affecting the cutting force and posing a risk of damage or falling out of the blade, which can be very dangerous.
- If the blade is not tightened properly, a warning beep will sound and the operation button will not work.
- Make sure the blade and blade fixture is inserted all the way in and tighten the hex bolt firmly with a torque wrench.
- Ensure that the set screw is tightly fastened.

► If the bolt is worn during the replacement

- Replace it before the set screw gets worn out.
- If the worn bolt cannot be removed, contact the manufacturer or distributor.

► Finally

- Please replace the wrench tip with a new one if it is worn.
- If you replace the blade while the oscillator is hot, the set screw may become loose when the oscillator cools down.
- Check if the set screw is tightened before use. If it is loose, tighten it again before use.

Warnings and precautions for safety

- If the instructions are not followed, there is a risk of death or serious injury.
If the instructions are not followed, there is a risk of bodily harm or property damage.



Please keep away
from water.



Do not disassemble the device
under any circumstances.



Be careful of heat.

Warning

- Never touch the blade while the device is working.
- Do not touch the blade after use as it may still be hot and cause burns.
- Do not bend, twist, or place heavy objects on the cable.
- Do not place the device in a place where it can come into contact with any liquid.
- Immediately stop use if it comes into contact with any liquid.
- Do not use the device with a damaged cable or adapter.
- Do not use it on highly flammable materials such as oil paper.
- Do not look directly at the blade or point it toward a person during use.
- Do not use it on any objects which may have electrical current flowing through it.
- When unplugging the adapter, always grab it by the plug to pull it out.
- Keep out of reach of children during use or storage.
- Do not subject the device to strong impacts.
- Do not disassemble, repair, or modify the device.
- Do not insert metal objects such as pins or wires into the openings.
- Do not burn the device.
- This device cannot be used on **metal** or **glass**. Please keep this in mind.

Warnings and precautions for safety

► Please do not use the product in following locations

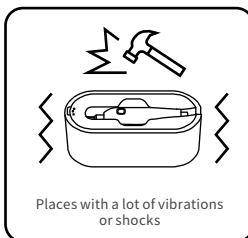
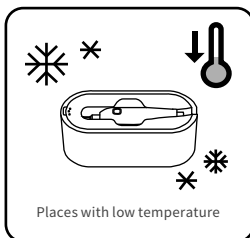
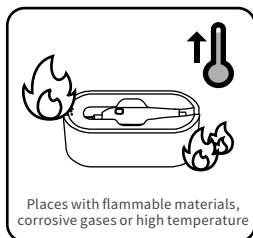

Warning

- If there are any abnormalities such as odor or smoke during use, immediately turn off the power.
- Turn off the power when replacing the blade or performing maintenance work.
- Do not use CtrlAX for any purpose other than its intended use.
- Ensure that the blade is securely fixed and use it only when there are no abnormalities.
- Use the designated blade. Using a blade other than the designated one can cause malfunction or separation of the blade, which can be extremely dangerous.
- Do not throw away old blades as general waste after use, but dispose them as hazardous waste in the manner specified by each local government.
- Do not use the device near any precision control devices or electrical equipment.
- Hold the handpiece properly during use.
- Do not apply unnecessary force to the end of the blade. The blade, the blade fixture, or the oscillator may break.
- When not using the handpiece, turn off the power and place the handpiece right on the main body.
- Depending on what material you use it on, any harmful substances or gases to the human body may be generated. Please check before use.
- Be careful not to apply any force to the device.

► Consumer Compensation Guidelines

- CUTRA Co., Ltd. provides a 1-year product warranty after purchase.
CUTRA will repair any damages caused by manufacturing defects or faulty parts that occur during the warranty period.
* No A/S cost will be charged during the warranty period of one year, but costs may be charged if the need for repair is due to consumer's fault.
* If the warranty period has expired, A/S costs may be charged. But depending on the symptoms, there may be no cost.
- If a manufacturing defect or faulty part occurs within 2 weeks of a product purchase, you can request an exchange.
- When receiving repair or exchange services during the warranty period, you must provide proof (such as s receipt) that the date of your service application is within the warranty period.
- You cannot receive free product warranty services for damages caused by an improper use or mishandling by the user, or any damages caused due to repairs or modifications performed by anyone other than CUTRA's designated service technician.
- The warranty becomes void if you attempt to disassemble the product.
- To use the product correctly, the user must strictly adhere to all instructions and warnings specified in the user manual. Avoid any actions or uses that are not recommended or warned against in the user manual.
- Do not use the product if the cable is damaged or scratched. If the cable is damaged, it must be repaired by CUTRA or an authorized distributor.
- Consumables or accessories such as blades, set screws, blade fixtures, and torque wrenches are not covered by the warranty.

► Product Specifications

- Model name	CtrIAX	- Voltage	100v ~ 240v(50/60Hz)
- frequency	40kHz	- Adapter specifications	24V/2A
- Body dimensions	198x72x90mm	- Storage temperature	0°C~45°C
- Product weight	About 560g	- power consumption	24w
- handpiece specifications	25x113mm	- handpiece weight	About 80g

Before asking for repairs

► Please check the following items before requesting repair.

Symptoms	Checklist	Solution
The power won't turn on.	Does the LED of the power button not light up?	Connect the adapter to the main body.
	Does the power still not turn on even after connecting the adapter?	Please contact the manufacturer or distributor.
The device does not work after pressing the operation button.	Is the power button turned off?	Press and hold the power button for 2 seconds to turn on the power.
	After pressing the operation button, did you let go of it too quickly?	Press and hold the operation button to work or use the continuous operation mode.
	Is the LED of the operation button not light up?	It is in circuit protection mode. Turn off the power, tighten or remove the loose set screw and allow it to cool down sufficiently before turning on the power again.
	Does it not work after switching to continuous operation mode?	After switching from normal to continuous operation mode, you need to press the operation button once to start it (check the handpiece LED).
The handpiece makes noise and does not cut well.	Is the blade securely fixed?	Use the torque wrench to tightly secure the blade and blade fixture with the set screw. (Tighten it until you hear a 'clicking' sound.)
	Is the blade or blade fixture broken or contaminated?	Clean the inside of the oscillator that goes into the blade fixture with a cotton swab. (The blackened bottom of the oscillator is due to friction with the blade fixture and does not affect performance.)
	Is there any foreign matter attached to the tip of the blade or the oscillator?	If the blade fixture is broken, replace it with a new one.
	Are you using the designated blade?	Using a different blade may cause product malfunction. Please use the manufacturer's designated blade.

Before asking for repairs

► Please check the following items before requesting repair.

Symptoms	Checklist	Solution
The handpiece is getting hot.	Have you been using the product for a long time?	If you are cutting hard or thick materials, heat can be generated quickly, and it will automatically switch to standby mode after one beep sound.
	Are you applying excessive force to the blade?	This product is a simple ultrasonic cutting machine for work. Hold it correctly and do not apply excessive force during use.
	Is the blade or blade fixture firmly fixed?	If the blade is not firmly fixed, a lot of heat loss can occur, which can reduce the lifespan of the product.
	Is the blade, the blade fixture, and the inside tip of the oscillator contaminated?	Clean the inner surface of the oscillator where the blade fixture is inserted with a cotton swab.
The ultrasonic vibration has stopped.	Are you applying excessive force to the operating button?	Release the force and try again. If you try to cut hard materials by applying excessive force, there will be a beep sound and the handpiece will stop working.
		It is in a high-temperature stop state. Please wait until the handpiece temperature cools down and then try again. (Wait for about 5 minutes for it to cool down.)
	Was there a beep sound? (Refer to page 4)	The protective function has been activated. Turn off the power button, check the condition of the blade fixture, and turn on the power again.
		Check if the set screw is tightly fastened. If the blade is heavily contaminated, replace it with a new one. Check if the blade fixture is broken.

► Recommended materials for use



Plastic

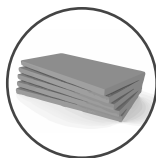

Expanded pvc foam

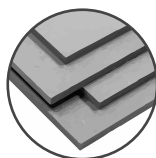

Plywood



Acrylic



rubber



leather



Foam filament



ABS



Vacuum former
sheet



PCB

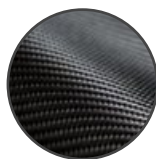

Carbon fiber

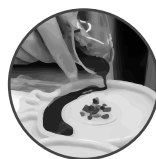

Resin

► Certificate



Certificate of
patent



Certificate of
Trademark
Registration



Gold prize
44th
Salon International
Des Inventions
Geneve



Gold Prize
Silicon Valley
International
Invention Festival



Gold prize
Seoul International
Invention Fair 2016

KICKSTARTER

Total Backer

850

Total Funding

\$ 362,887

In 54 Countries



ALGERIA	ESTONIA	ISRAEL	PHILIPPINES	SOUTH KOREA
AUSTRALIA	FINLAND	ITALY	POLAND	SPAIN
AUSTRIA	FRANCE	JAPAN	PORTUGAL	SWEDEN
BAHRAIN	GEORGIA	KAZAKHSTAN	PUERTO RICO	SWITZERLAND
BELGIUM	GERMANY	LUXEMBOURG	ROMANIA	TAIWAN
BOLIVIA	GREECE	MALAYSIA	RUSSIA	THAILAND
CANADA	HONGKONG	MEXICO	SAUDI ARABIA	UNITED ARAB EMIRATES
CHILE	HUNGARY	NETHERLANDS	SINGAPORE	UNITED KINGDOM
CZECHIA	INDIA	NEW ZEALAND	SLOVAKIA	UNITED STATES
DENMARK	INDONESIA	NICARAGUA	SLOVENIA	
EGYPT	IRELAND	NORWAY	SOUTH AFRICA	

Featured on

Bloomberg



YAHOO!
JAPAN

rakunew



AEIFFELPOST

LOUISPRESS

FRONE

ROMANTICITY

EULEADER

LPSBIZ

ÉconomieFR

PROVANCEDAILY

FFTRIBUNE

WDPP
WORLD DEVELOPMENT PRESS

Ctrl/AX

CUTRA CO.,LTD.

📍 Songdo Technopark BT Center #1113, #1114, Songdogwahak-ro 56,
Yeonsu-gu, Incheon, Republic of Korea 21984

+82 070-7767-0927 📞 | 🌐 ctrlax.com

wondercutter@naver.com ✉ | 📺 www.youtube.com/@CUTRAFT